

THIS DRAWING AND THE INFORMATION CONTAINED ARE THE PROPERTY OF COSELLA-DÖRKEN. THEY ARE NOT TO BE COPIED OR USED IN ANY WAY WITHOUT OUR WRITTEN PERMISSION

COSELLA DÖRKEN

4655 DELTA WAY BEAMSVILLE, ON. L0R 1B4 CANADA
TEL# 1-888-433-5824 OR 1-905-563-3255

THIS IS A PROPOSAL DRAWING. DO NOT USE FOR CONSTRUCTION UNTIL APPROVED BY CONTRACTOR OR CONSULTING ENGINEER

TITLE:

SOIL GAS VENTILATION SYSTEM WITH FOUNDATION WALL AND FLOOR SLAB AT FOOTING LEVEL (NEW CONSTRUCTION)

APP'D BY:

DATE:

DRAWN BY: KRZYSZTOF APRIASZ.

CHKD BY:

DATE: April 5, 2011

SCALE: NTS

FILE NAME: DELTA-MS_SoilGas3.dwg

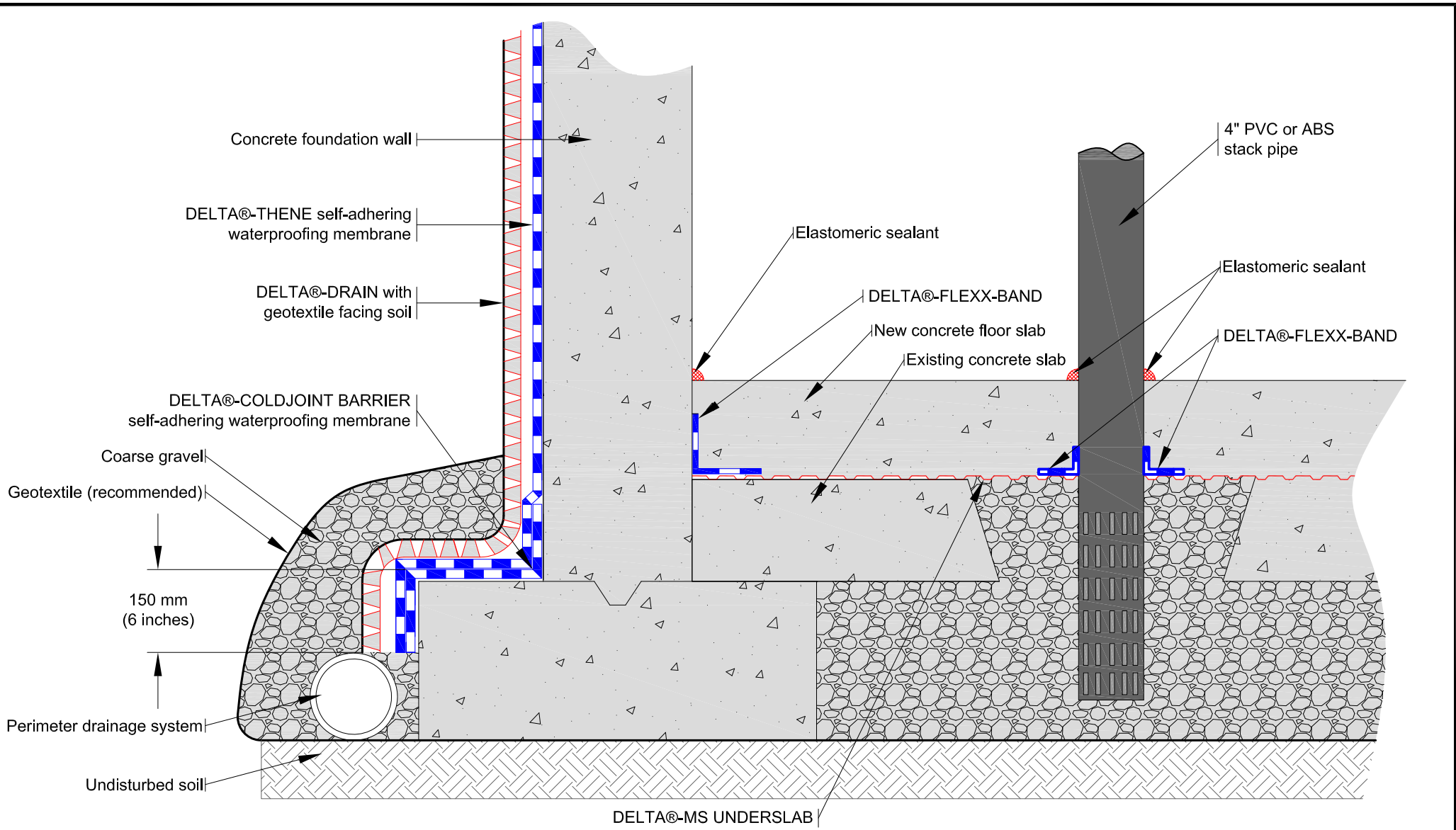

THIS DRAWING AND THE INFORMATION CONTAINED ARE THE PROPERTY OF COSELLA-DÖRKEN. THEY ARE NOT TO BE COPIED OR USED IN ANY WAY WITHOUT OUR WRITTEN PERMISSION

COSELLA DÖRKEN

4655 DELTA WAY BEAMSVILLE, ON. L0R 1B4 CANADA
TEL# 1-888-433-5824 OR 1-905-563-3255

THIS IS A PROPOSAL DRAWING. DO NOT USE FOR CONSTRUCTION UNTIL APPROVED BY CONTRACTOR OR CONSULTING ENGINEER

TITLE: **SOIL GAS VENTILATION SYSTEM WITH FOUNDATION WALL AND EXISTING FLOOR SLAB AT FOOTING LEVEL (RETROFIT)**

APP'D BY: _____ DATE: _____

DRAWN BY: KRZYSZTOF APRIASZ.

CHKD BY: _____

DATE: April 5, 2011

SCALE: NTS

FILE NAME: DELTA-MS_SoilGas4.dwg