

DELTA[®] protects property. Saves energy. Creates comfort.



DELTA[®]-REFLEX

**100 % Air and Vapor-Tight!
Who Can Top That?**

The Rugged, Highly Flexible 4-Ply Composite.
Saves Energy and Cuts Costs.



PREMIUM QUALITY

Also as DELTA[®]-REFLEX PLUS, with
integrated self-adhesive border.

 Vapor
Barrier Sheet

 For all
Roof Designs

 For New
Construction and
Refurbishment

The New Dimension
in Energy Savings?
It's DELTA® System!

It's What's Inside That Counts!

DELTA®-REFLEX

10 % More Insulation. 50 % Heat



■ Inside:

DELTA®-REFLEX

Vapor barrier sheet with the insulation system warranty. Fulfills the requirements of DIN 4108 in all ventilated and non-ventilated roof constructions when used in combination with DELTA® roof underlays and conventional insulation materials.

■ Outside:

DELTA®-MAXX PLUS

Energy-Saver Membrane

This advanced roofing underlay puts an end to high energy losses due to cold air draughts.

■ 4-layer composite. Rugged, strong, flexible and easy to install.

■ DELTA®-REFLEX PLUS with integrated self-adhesive edge for airtight joints.

■ S_d value > 100 m. This extremely high vapor resistance stops moisture migration which can cause serious damage to the insulation and the roof system.

■ High shielding effectiveness against electrosmog.

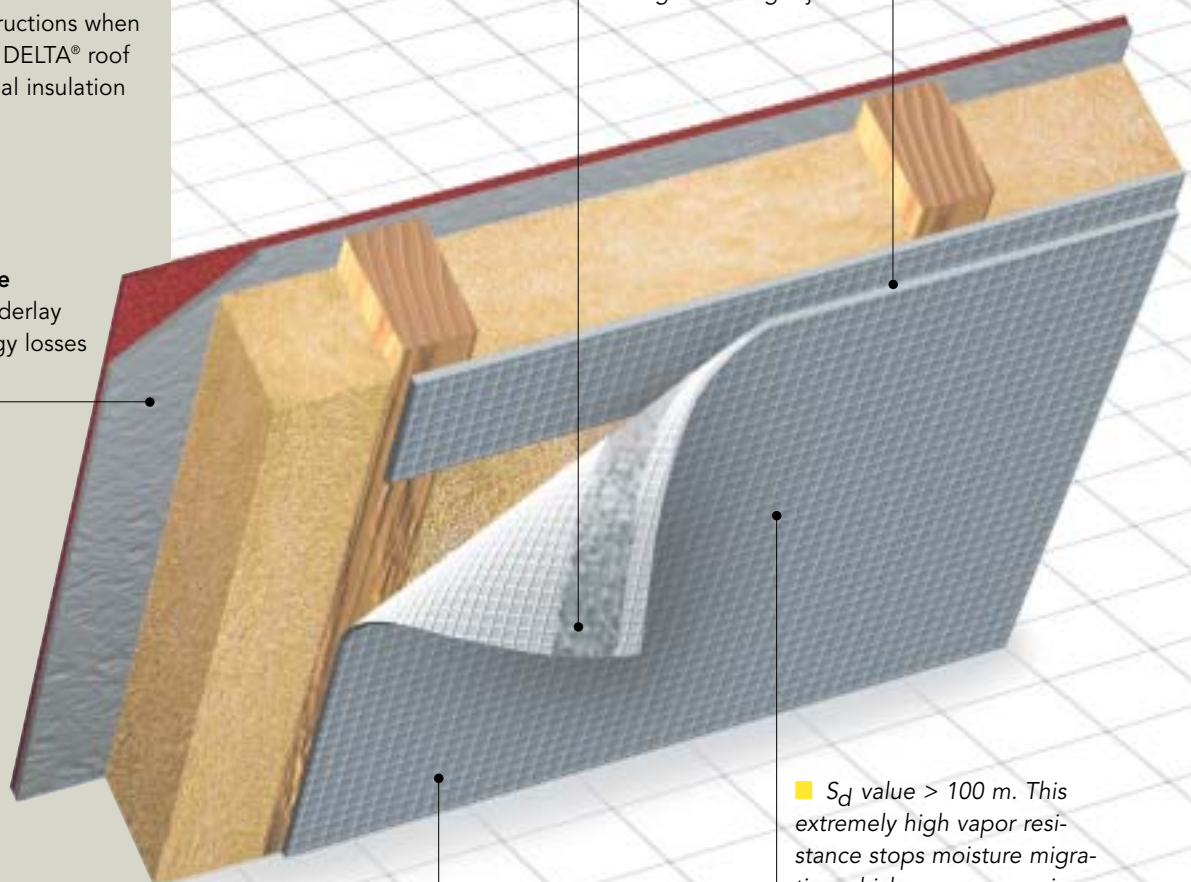

PREMIUM QUALITY



DELTA®-REFLEX PLUS with integrated self-adhesive edge. Typical application on lightweight industrial roof.

Installation is made easy by DELTA® system components.

100 % Air and Vapor-Tight.

DELTA®-REFLEX ...

- ... enhances thermal insulation by up to 10 %.
- ... shields off 30 % of hazardous electromagnetic radiation.
- ... achieves 50 % heat reflectance as certified by Fraunhofer Institute in Freiburg/Germany.
- ... creates a 100 % air and vapor tight seal.
- ... maintains a perfect air and vapor-tight seal at all overlap seams and connections joined with DELTA®-TIXX sealant, DELTA®-KOM-STRIP, DELTA®-POLY-TAPE and DELTA®-FLEXX-TAPE.
- ... has excellent fire resistance, conforms to strict B1 rating of DIN 4102 (Cert. No. Z-PA-III/2.1268).
- ... has outstanding tensile strength (450 N/5 cm) due to its built-in reinforcing grid.
- ... is in the available width of 3 m ideal for use on lightweight industrial roofs incorporating e.g. aerated concrete or trapezoidal sheet decking.
- ... has an s_d value (diffusion-equivalent air blanket) of over 100 m.
- ... conforms fully with requirements of DIN 4108 when properly installed.
- ... has outstanding flexibility, allowing rapid installation.

DELTA®-REFLEX PLUS with the integrated self-adhesive edge provides even more energy savings and faster airtight installation.



DELTA®-REFLEX – the universal vapour barrier sheet.

Here are the benefits of the DELTA® System.

Inside ...

... DELTA®-REFLEX vapor barrier sheet. The energy-saving 4-ply composite sheet with high strength and flexibility - with the insulation system guarantee.

Outside ...

... DELTA®-MAXX PLUS, the energy-saving, wind-tight breather underlay. Ensures big energy savings down to the smallest detail.



Needless to say, we have a range of perfect accessories, about which you find additional information on the next page.

DELTA®-REFLEX

Technical Data Overview:

Material	Watertight, corrosion-proof aluminium layer laminated between transparent polyester film and grid-reinforced polyethylene film
Application	Vapour barrier sheet with high safety factor
Fire behaviour	High fire resistance, B1 rating/DIN 4102 (Test cert. Z-PA-III/2.1268)
Tensile strength	apprx. 450 N/5 cm according to DIN 12311 in both directions
S _d value	over 100 m
Thermal behaviour	Stable between -40 °C and +80 °C
Weight	apprx. 180 g/m ²
Roll weight	apprx. 13.5 kg
Roll sizes	50 m x 1,5 m 25 m x 3 m

Vapor Barrier Sheets are not resistant against permanent UV attack. Sheets installed in areas with ongoing UV radiation have to be covered.

DELTA®-Accessories for DELTA®-REFLEX.

Cosella-Dörken makes your life easier – systematically.

You are sure to appreciate these handy DELTA®-Accessories:



DELTA®-TIXX

Sealing compound for airtight connection of vapour barrier sheet to brick walls. No finish stripping required.



DELTA®-FLEXX-TAPE

Stretchable sealing tape for inner and outer connections to structural details such as skylights, dormer windows, ventilator exhaust pipes, cables etc.



DELTA®-POLY-TAPE

Aluminized adhesive tape for sealing of overlapping DELTA®-REFLEX sheets. Or – as an alternative – use DELTA®-REFLEX PLUS with the integrated self-adhesive edge.



DELTA®-KOM-TAPE

Pre-compressed acrylate-saturated soft-foam sealing tape.

DELTA®

DELTA® System ...

... for owners:

"... What I get is a mature problem solution provided at a fair price by a top specialist in quality branded products!"

... for workers:

"... What I get is a complete system made by a single manufacturer that enables me to do anything to the owner's entire satisfaction. There is no safer way!"

... for planners:

"... I can be certain that both innovative and standard products will be used in implementing my roof and cellar plans in a systematic and forward-looking way."



COSELLA DÖRKEN

Cosella-Dörken Products Inc.
4655 Delta Way
Beamsville, Ontario
LOR 1B4
(905) 563-3255
Fax: (905) 563-5582
1-888-4 DELTA 4
info@cosella-dorcken.com
DELTAMS.com

A company of the Dörken Group